

Surface Mount Box

With Shielded FT Series Keystone Jacks

Surface Mount Box are an integral part of horizontal subsystems of SCS and are intended for connection of terminal equipment in workplaces. Structurally, the sockets can be made in two versions: as a complete solution with soldered RJ45 ports and IDC connectors and in the form of a plastic casing into which Keystone plug-in modules are separately installed.

These outlets are equipped with NIKOMAX Fast Termination («FT» series) Keystone Jacks and represent a solution completely ready for installation. The «FT» series Keystone modules are designed specifically for use with the NMC-FT-TOOL, which allows you to terminate the module in one push. More information about the tool and «FT» modules you can read in the relevant sections.

On the casings of the outlets there are additional break-out windows allowing cables to be brought from either side. For ease of administration on all covers there are marking areas and windows for the installation of colored icons.

With plug-in modules, you can always change the configuration of the outlets. Any other Keystone format modules can be installed there in any desired configuration.

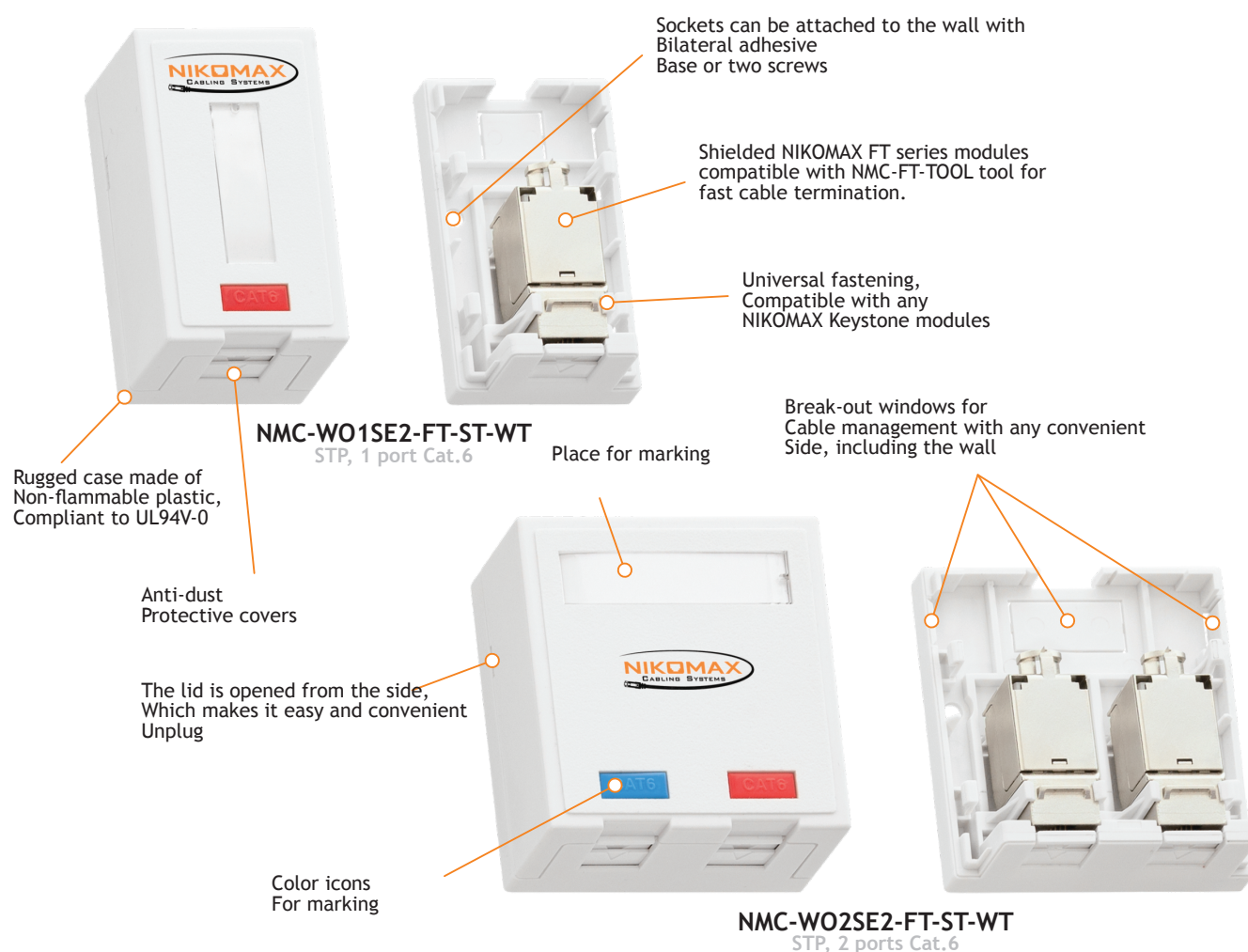

Accessories

Punch down tools:
NMC-FT-TOOL
NMC-3640RB

Cable Cutter:
NMC-502C
NMC-222

Cable Stripper:
NMC-S501B

The manufacturer reserves the right to alter the appearance and characteristics of the product, without compromising the product's functionality

Surface Mount Box

With Shielded FT Series Keystone Jacks

Specification

	NMC-WO1SE2-FT-ST-WT	NMC-WO2SE2-FT-ST-WT	NMC-WO1SD2-FT-ST-WT	NMC-WO2SD2-FT-ST-WT
Number of ports	1	2	1	2
Installed modules	NMC-KJSE2-FT-MT		NMC-KJSD2-FT-MT	
Category	6		5e	
Bandwidth (MHz)	250 MHz		100 MHz	
Type	Fully shielded			
Type of connectors	RJ45/8P8C			
Material of connector contact	Phosphor bronze			
Material of contact plating	Gold (50 micro-inches) Nickel (100 micro-inches)			
Durability (mating cycles)	Not less than 750 times			
Type of IDC contacts	FT-TOOL fast termination tool or 110 / KRONE Type			
Wiremap	T568A/B			
Diameter of conductor	~24-22 AWG (0.50-0.65 mm)			
Material of IDC contact	Phosphor bronze			
Material of IDC Contact Plating	Tin (100 micro-inches)			
Material of Module housing	Zinc-aluminum alloy			
Insulation resistance (Ω)	At least 500 M (at a constant voltage of 100 V)			
Dielectric Withstand Voltage	Up to 1000 V, 60 Hz for 1 minute			
Contact resistance (μΩ)	No more than 20			
IDC contact resistance (μΩ)	No more than 2.5			
Compliance	ISO/IEC 11801, EN 50173 and ANSI / TIA-568-C.2			
Application	10BASE-T, 100BASE-TX, 100BASE-T4, 1000BASE-T, 10G-BASE-T (For Cat. 6), ATM-25, ATM-51, ATM-155, 100VG-AnyLan, TR-4, TR-16 Active, TR-16 Passive			
Housing material	High strength, non-flammable, meets UL94V-0			
Color	White			
Installation	Wall			
Dimensions, WxHxD	40x70x30 mm	66x70x30 mm	40x70x30 mm	66x70x30 mm
Temperature rangs	Storage -40 to +70°C. Installation from 0 to +50°C. Operating from -10 to +60°C			
Packaging	Individual - Plastic bag			
Warranty	Extended - 5 years. 25 years - as part of the NIKOMAX structured cabling systems.			

Package Content

	NMC-WO1SE2-FT-ST-WT	NMC-WO2SE2-FT-ST-WT	NMC-WO1SD2-FT-ST-WT	NMC-WO2SD2-FT-ST-WT
Socket housing	1 pc.	1 pc.	1 pc.	1 pc.
Module + Cover	1 pc.	2 pcs.	1 pc.	2 pcs.
Grounding wire	1 pc.	2 pcs.	1 pc.	2 pcs.
Cable tie	1 pc.	2 pcs.	1 pc.	2 pcs.
Installation instructions	1 pc.	1 pc.	1 pc.	1 pc.
Label for marking	1 pc.	1 pc.	1 pc.	1 pc.
Set of colored icons	2 pcs.	2 pcs.	2 pcs.	2 pcs.
Sticky base	1 pc.	1 pc.	1 pc.	1 pc.
Screw	2 pcs.	2 pcs.	2 pcs.	2 pcs.

Ordering Table

Part Number	Cat.	Ports	Individual package		Collective package			Freight package		
			Volume, m ³	Weight, kg	Q'ty	Dimensions, mm	Weight, kg	Q'ty	Dimensions, mm	Weight, kg
NMC-WO1SE2-FT-ST-WT	6	1	0.00009	0.058	50 pcs.	250x190x210	3.2	200 pcs.	515x400x230	13.4
NMC-WO2SE2-FT-ST-WT	6	2	0.00015	0.098	35 pcs.	250x190x210	3.5	140 pcs.	515x400x230	15.5
NMC-WO1SD2-FT-ST-WT	5e	1	0.00009	0.058	50 pcs.	250x190x210	3.2	200 pcs.	515x400x230	13.4
NMC-WO2SD2-FT-ST-WT	5e	2	0.00015	0.098	35 pcs.	250x190x210	3.5	140 pcs.	515x400x230	15.5

The manufacturer reserves the right to alter the appearance and characteristics of the product, without compromising the product's functionality