

- NMC-WO1UE2-WT — 1 port, Cat.6
- NMC-WO2UE2-WT — 2 ports, Cat.6
- NMC-WO1UD2-WT — 1 port, Cat.5e
- NMC-WO2UD2-WT — 2 ports, Cat.5e

## NIKOMAX Surface mounting outlets, Unshielded RJ45/8P8C, 110/KRONE, T568A/B, Built-in PCB, White

Surface Mounting boxes are a part of SCS horizontal subsystems. They designed for connection of terminal equipment on the workplaces. Structurally, the outlet can be made in two versions: as a complete solution with build-in PCB with IDC and RJ45 ports and as a universal mounting box with a set of separately installed Keystone jacks. Surface Mount Box with build-in PCB are less versatile, but more affordable solution.

NIKOMAX wall outlets are made in strict design cases with durable plastic. They are supplied as a complete, ready to use solution.

SMBs with build-in PCB are supplied in shielded and unshielded versions, categories 5e and 6 and can offer a good transmission characteristics. Contacts in the RJ45 sockets protected with 50 microinch gold plating. Flush contacts (IDC) compatible with both types of knives (110 & KRONE), making them easy for install with punch down tool.

The Surface Mounting Boxes housing provides additional break out windows, allowing to bring the cables from any side. All covers are supplied with paper labels and additional colored icons for marking and administrative convenience.

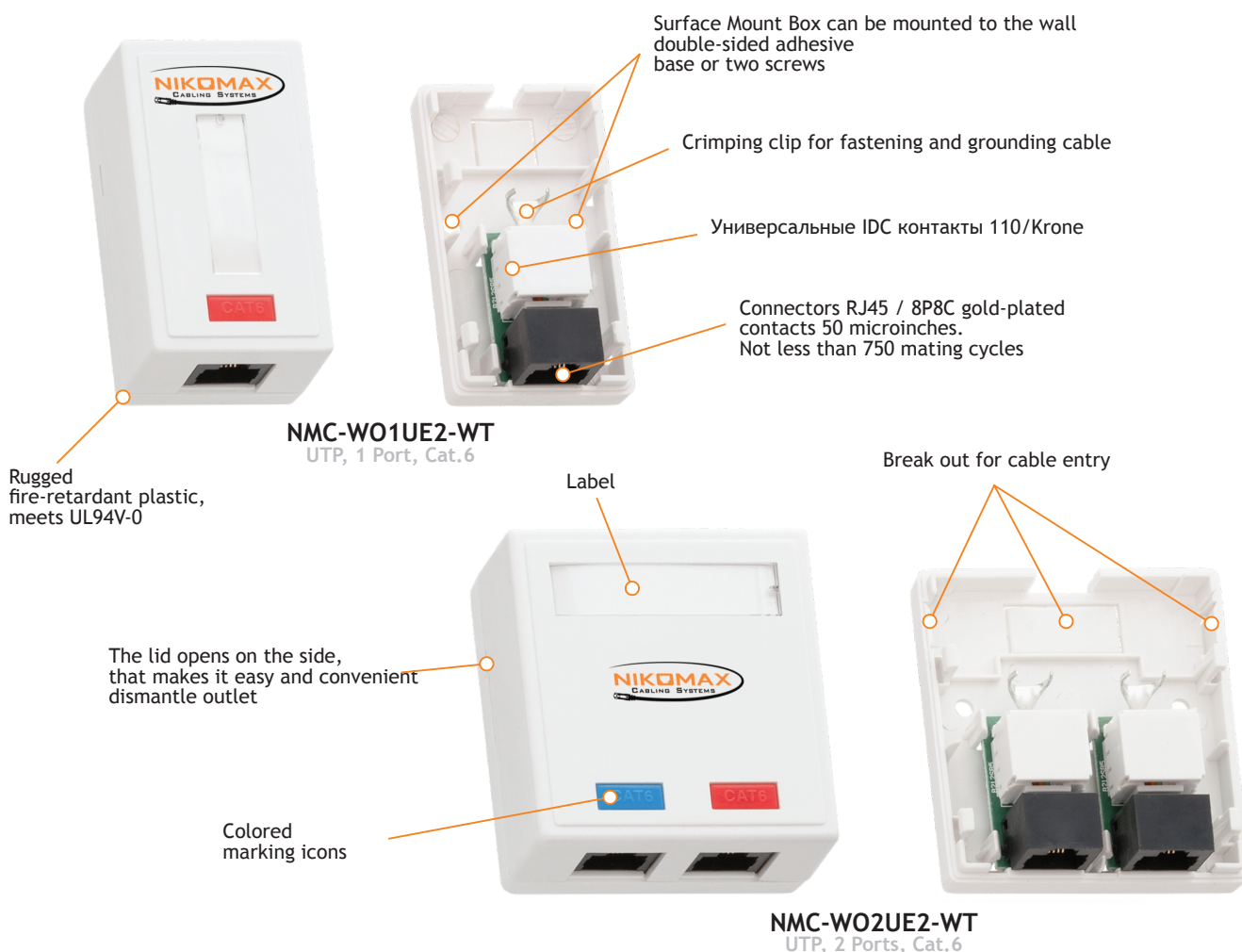

## Specification

	NMC-WO1UE2-WT	NMC-WO2UE2-WT	NMC-WO1UD2-WT	NMC-WO2UD2-WT
Number of ports	1	2	1	2
Format	Keystone Jack			
Category	6		5e	
Bandwidth (MHz)	250 MHz		100 MHz	
Type	Unshielded			
Type of connectors	RJ45/8P8C			
Material of connector contact	Phosphor bronze			
Material of contact plating	Gold (50 micro-inch) Nickel (100 micro-inch)			
Durability (mating cycles)	Not less than 750 times			
Type of IDC contacts	110 / KRONE Type			
Wiremap	T568A/B			
Diameter of conductor	~24-22 AWG (0.50-0.65 mm)			
Material of IDC contact	Phosphor bronze			
Material of IDC Contact Plating	Tin (100 micro-inch)			
Insulation resistance	Gold (50 micro-inch) Nickel (100 micro-inch)			
Dielectric Withstand Voltage	Up to 1000 V, 60 Hz for 1 minute			
Contact resistance	No more than 20 M ohms			
IDC contact resistance	No more than 2.5 M ohms			
Compliance	ISO/IEC 11801, EN 50173 and ANSI / TIA-568-C.2			
Application	10BASE-T, 100BASE-TX, 100BASE-T4, 1000BASE-T, ATM-25, ATM-51, ATM-155, 100VG-AnyLan, TR-4, TR-16 Active, TR-16 Passive			
Housing material	High strength, non-flammble, meets UL94V-0			
Color	White			
Installation	Wall			
Dimensions, WxHxD	40x70x30 mm	66x70x30 mm	40x70x30 mm	66x70x30 mm
Temperature ranges	Storage -40 to +70 °C. Installation from 0 to +50 °C. Operating from -10 to +60 °C			
Packaging	Individual - Plastic bag			
Warranty	Extended - 5 years. 25 years - as part of the NIKOMAX structured cabling systems.			

## Package Content

	NMC-WO1UE2-WT	NMC-WO2UE2-WT	NMC-WO1UD2-WT	NMC-WO2UD2-WT
Power socket	1 pc.	1 pc.	1 pc.	1 pc.
Protective cover	1 pc.	2 pcs.	1 pc.	2 pcs.
Marking Label	1 pc.	1 pc.	1 pc.	1 pc.
Colored icon set	2 pcs.	2 pcs.	2 pcs.	2 pcs.
Sticky base	1 pc.	1 pc.	1 pc.	1 pc.
Screws	2 pcs.	2 pcs.	2 pcs.	2 pcs.

## Ordering Table

Part Number	Category	Ports	Individual package		Collective package			Freight Packing		
			Volume, m <sup>3</sup>	Weight, kg	Q'ty	Dimensions, mm	Weight, kg	Q'ty	Dimensions, mm	Weight, kg
NMC-WO1UE2-WT	6	1	0.00008	0.040	40 pcs.	190x160x280	1.6	240 pcs.	585x280x345	10.5
NMC-WO2UE2-WT	6	2	0.00013	0.060	30 pcs.	190x160x280	1.9	180 pcs.	585x280x345	12.3
NMC-WO1UD2-WT	5e	1	0.00008	0.040	40 pcs.	190x160x280	1.6	240 pcs.	585x280x345	10.5
NMC-WO2UD2-WT	5e	2	0.00013	0.060	30 pcs.	190x160x280	1.9	180 pcs.	585x280x345	12.3

## Accessories

Punch Down tool:  
NMC-3640RB

Cable Cutter:  
NMC-502C  
NMC-222

Cable Stripper:  
NMC-S501B

The manufacturer reserves the right to alter the appearance and characteristics of the product, without compromising the product's functionality